

DCT-705P

Redefining the standard in vandal resistant loudspeaking telephones, this compact and stylish unit, with its strong stainless steel construction is suitable for use at sites prone to vandalism or harsh weather conditions.

A remotely activated internal relay is provided for use in security applications where doors or boom gates need to be opened. The unit can be flush mounted into a wall or surface mounted with an optional enclosure. (see reverse)

Capable of being programmed remotely via a standard telephone, the unit can be adapted and changed when required by a single phone call to site.

No power supply is needed, the unit is telephone line powered and can be connected directly to a PSTN line or PABX system.

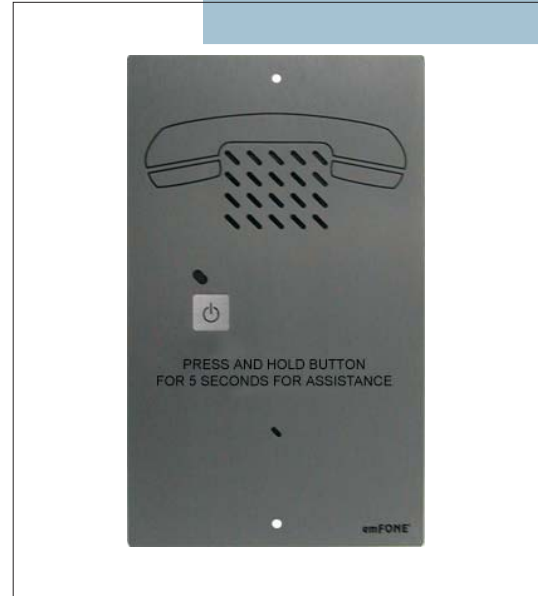

Features

- Telephone line powered.
- Hands free communication.
- Vandal resistant stainless steel construction.
- 32 digit dialing capacity.
- PABX pause option.
- Call progress tone detection.
 - Busy tone.
 - Continuous tone.
 - Silence.
- Maximum length conversation timer.
- Programmable door release relay.
- EEPROM memory storage, with 100-year data retention.
- Low current micro controller.
- Remote programmable.
- Up to 80db speaker volume.
- LED status indicator.

*Telephone line
powered,
vandal resistant,
auto-dialing,
loudspeaking
telephone.*

DCT-705P

Models

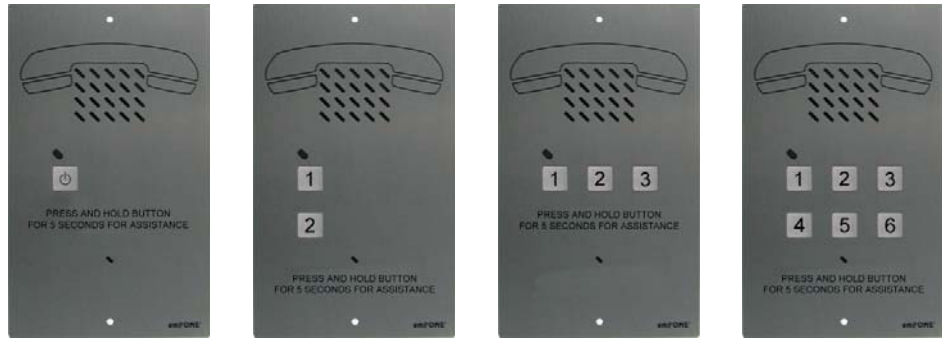

DCT-705P

DCT-705P/2

DCT-705P/3

DCT-705P/6

Measurements

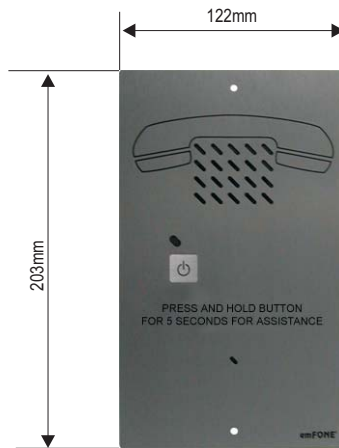

Front View

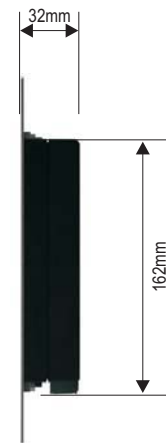

Side View

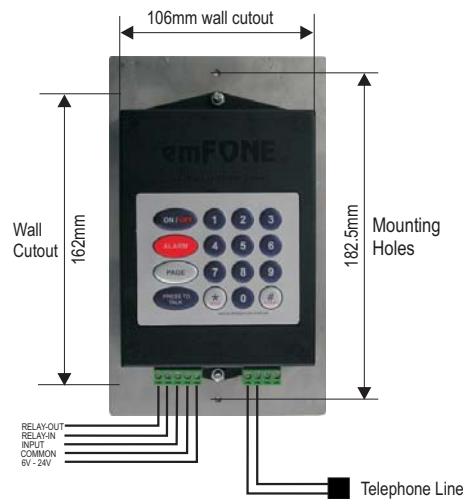

Wall cut out



Surface Mount Enclosure
Model: DCT-201

Specifications

Telephone Line	24V DC - 48V DC
Loop Current	20mA to 90mA Max
Dialing Method	DTMF 70msec ON - 70msec OFF
Call Progress Tones	350Hz to 620Hz
Busy Tone Cadance	300msec to 700msec "ON" 300msec to 700msec "OFF"
Speaker Volume	80dB dependant on loop current
Microphone Sensitivity	Adjustable, 5 meters
Relay Operating Voltage	12V Dc - 24V DC
Relay Contact Rating	1AMP 30V DC MAX N/O and N/C selectable

